

# MIDI FUSE BLOCK

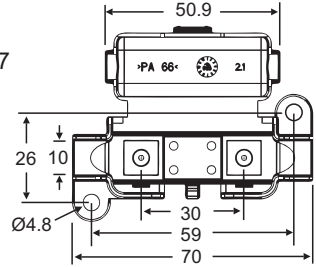

Part Number	Description
MIDFBB	Midi Fuse Block with Hinged Cover

**Voltage:** 32VDC **Rating:** 125A  
**Body & Cover:** Black PA66.  
**Accessories:** Includes cover & flanged nuts.  
**Studs:** M5 threaded studs. Steel / Zinc plated.  
**Torque Rating:** 4.5 Nm  
**Features:** Inline or surface mounting options.  
**Pack Size:** 1, 10, 100  
**Notes:** Midi fuse is not included.  
**Approvals:**

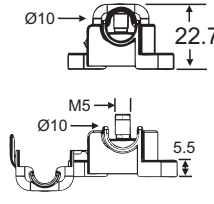

Dimensions in MM

## RELATED PRODUCTS:



**Midi Fuse**  
(See page 24)

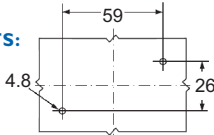

**Mounting Diagram**

# MEGA FUSE IN-LINE HOLDERS



Part Number	Fuse Holder Kits Include:
00380K1	1 x Set fuse holder bodies <b>NEW</b> 2 x Bolts (Steel M8 x 14) & 2 x nuts 2 x Terminals, 10 - 20mm <sup>2</sup> , 90A
00380K2	1 x Set fuse holder bodies <b>NEW</b> 2 x Bolts (Steel M8 x 14) & 2 x nuts 2 x Terminals, 25 - 35mm <sup>2</sup> , 100A

**IP20**

**Voltage:** 32V  
**Body:** PA66-GF30 HB  
**Terminals:** Tin plated copper **Torque Rating:** 11 Nm  
**Fuse Holder Kit Pack Size:** 1, 10, 100  
**Fixing Plate Pack Size:** 1000  
**Note:** Mega fuse & fixing plates not included.

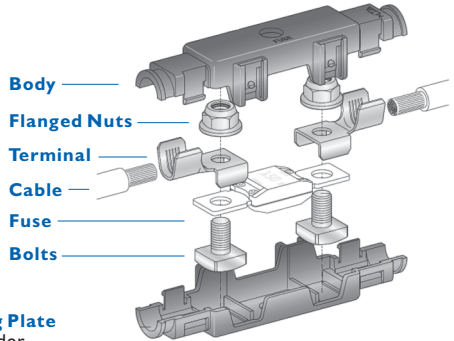

## Lateral Fixing Plate

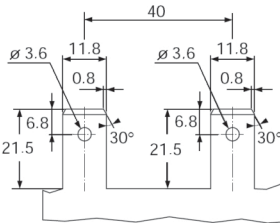

## Snap Mount Fixing Plate

Slide locks to holder.  
Snaps into to panel hole.

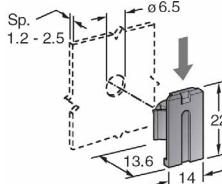

## RELATED PRODUCTS:



**Mega Fuses**  
(see page 25)

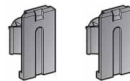

**Fixing Plates # 00395**  
(2pcs required per holder, indent item)

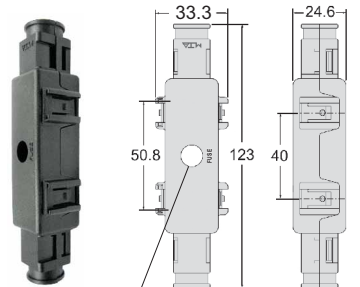

Fuse inspection window

Dimensions in MM