

Type FKE/90 Part Number	Type FKE/115 Part Number	Ampere Rating	Body Size	Total I <sup>2</sup> t at 660V
I70M3658	I70M3758	40A	0/1*	270
I70M3659	I70M3759	50A	0/1*	515
I70M3660	I70M3760	63A	0/1*	770
I70M3661	I70M3761	80A	0/1*	1 250
I70M3662	I70M3762	100A	0/1*	2 450
I70M3663	I70M3763	125A	0/1*	3 700
I70M3664	I70M3764	160A	0/1*	7 500
I70M3665	I70M3765	200A	0/1*	15 000
I70M3666	I70M3766	250A	0/1*	28 500
I70M3667	I70M3767	315A	0/1*	46 500
I70M3668	I70M3768	350A	0/1*	68 500
I70M3669	I70M3769	400A	0/1*	105 000
I70M3670	I70M3770	450A	0/1*	140 000
I70M3671	I70M3771	500A	0/1*	180 000
I70M3672	I70M3772	550A	0/1*	230 000
I70M3673	I70M3773	630A	0/1*	325 000
I70M4658	I70M4758	200A	I	11 500
I70M4659	I70M4759	250A	I	21 000
I70M4660	I70M4760	315A	I	42 000
I70M4661	I70M4761	350A	I	59 000
I70M4662	I70M4762	400A	I	91 500
I70M4663	I70M4763	450A	I	120 000
I70M4664	I70M4764	500A	I	170 000
I70M4665	I70M4765	550A	I	230 000
I70M4666	I70M4766	630A	I	350 000
I70M4667	I70M4767	700A	I	465 000
I70M4668	I70M4768	800A	I	725 000
I70M4669	I70M4769	900A ^	I	850 000
I70M5658	I70M5758	400A	2	74 000
I70M5659	I70M5759	450A	2	105 000
I70M5660	I70M5760	500A	2	145 000
I70M5661	I70M5761	550A	2	190 000
I70M5662	I70M5762	630A	2	275 000
I70M5663	I70M5763	700A	2	405 000
I70M5664	I70M5764	800A	2	575 000
I70M5665	I70M5765	900A	2	840 000
I70M5666	I70M5766	1000A	2	1 250 000
I70M5667	I70M5767	1100A	2	1 600 000
I70M5668	I70M5768	1250A	2	2 400 000
I70M6658	I70M6758	500A	3	95 000
I70M6659	I70M6759	550A	3	135 000
I70M6660	I70M6760	630A	3	210 000
I70M6661	I70M6761	700A	3	300 000
I70M6662	I70M6762	800A	3	465 000
I70M6663	I70M6763	900A	3	670 000
I70M6664	I70M6764	1000A	3	945 000
I70M6665	I70M6765	1100A	3	1 300 000
I70M6666	I70M6766	1250A	3	1 950 000
I70M6667	I70M6767	1400A	3	2 450 000
I70M6668	I70M6768	1500A	3	3 100 000
I70M6669	I70M6769	1600A	3	3 900 000
I70M6670	I70M6770	1800A#	3	5 250 000
I70M6671	I70M6771	2000A ^	3	6 350 000

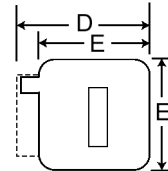

Fuses Fitted with Trigger Indicator and Microswitch Adaptor

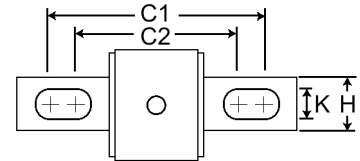
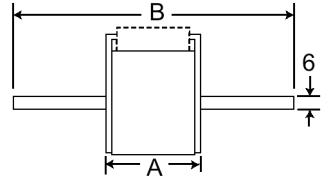

Body		Type FKE/90							
Size	A	B	C1	C2	D	E	H	K	
0/1*	50	110	85	72	59	45	20	10	
1	50	136	104	78	69	53	25	14	
2	50	135	105	78	77	61	25	14	
3	51	135	106	77	92	76	36	16	

Body		Type FKE/115							
Size	A	B	C1	C2	D	E	H	K	
0/1*	50	148	123	110	59	45	20	10	
1	50	157	126	100	69	53	25	14	
2	50	159	125	99	77	61	25	14	
3	51	155	125	97	92	76	36	16	

Dimensions in MM

I.R.: 200kA at rated voltage  
**Voltage:** 700VAC (UL), 690VAC (IEC), #600VAC (IEC), ^550VAC (IEC).  
**Operating Class:** aR  
**Holders:** Blocks (contact sales for details)  
**Microswitch (Type K):** I70H0069 (p148)  
**Notes:** Bussmann Body Size I\* = Size 0.

**Pack Size (box):** 3  
**Approvals:** IEC