

# ZCASE M8 FUSE BATTERY STUD MOUNT BARS 1 POLE



**NEW**

The Littelfuse ZCASE® SMZ Series Stud Mount Fuse Holder reduces the need for wiring and parts by allowing ZCASE® single high-current fuses to be directly installed on an alternator, battery switch, or electrical relay.

**Features:**

- Up to 3 fuse holders can be stacked to protect multiple circuits.
- Space-saving design eliminates the need to wire in a separate fuse holder or power distribution module (PDM).
- Cover offered in 2 styles. Fuse only or fuse and mounting stud.



**Fuse Bar with Fuse-Stud Cover**



**Fuse Bar with Fuse Cover**

Part Number	Description - 1 Pole Fuse Bar
0FHZ0201Z	Fuse Bar, M8 Mount with Fuse-Stud Cover
0FHZ0202Z	Fuse Bar, M8 Mount with Fuse Cover
0FHZ0211Z	Fuse Bar, M10 Mount with Fuse-Stud Cover
0FHZ0212Z	Fuse Bar, M10 Mount with Fuse Cover

**Voltage:** 80VDC

**Rating:** 300A continuous. 400A max.

**Operating Temp.:** -40°C to 105°C.

**Fuse Terminal:** Isolated stud M8.

**Cover:** Red UL 94 V-0 rated

**Fuse Busbar:** Tin-plated copper busbar.

**Torque M8 Nut:** 14 Nm

**Kit Contents:** Includes Fuse Bar, Cover & Nut.

**Notes:** Zcase fuse not included.



**Multiple Mounting Arrangement**



**Single Pole M8 Isolated Fuse Terminal Pictured Without Fuse**

**RELATED PRODUCTS:**



**Zcase M8 fuse & Shunt**  
(see page 4)

**MRBF M8 fuse**

# ZCASE M8 FUSE BATTERY POST MOUNT BARS 2 & 3 POLES



**NEW**

Part Number	Description
0FHZ00854-BX	2 Pole fuse bar kit & cover
0FHZ00853-BX	3 Pole fuse bar kit & cover

**Voltage:** 32VDC

**Rating:** 275A max continuous.

**Fuse Terminal:** Isolated studs M8.

**Torque:** 12 to 16 Nm

**Mounting:** Top Post Positive 19mm.

**Kit Contents:** Includes Battery Bar, Fuse Bar, Cover, S/S Nuts & Washers.

**Operating Temp.:** -40°C to 125°C.

**Notes:** Zcase fuse not included.



**3 Pole M8 Isolated Fuse Terminals**



**2 Pole M8 Isolated Fuse Terminals**

**RELATED PRODUCTS:**



**Zcase M8 fuse & Shunt**  
(see page 4)

**MRBF M8 fuse**

**Red cover fitted.**  
(Included in kits)

**DIMENSIONS FOR: 0FHZ0212Z & 0FHZ0211Z**

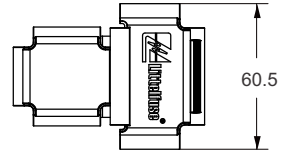
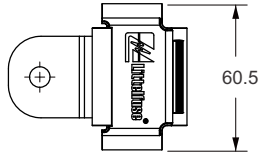
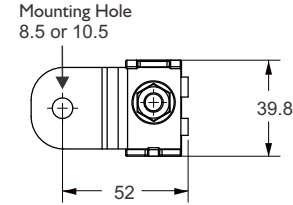

**Fuse Bar**

**0FHZ0212Z  
Fuse Cover**

**0FHZ0211Z  
Fuse & Stud Cover**

M8x I.25 Serrated Flange Nut  
To Fix Zcase Fuse & Wire Terminal

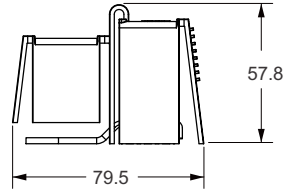
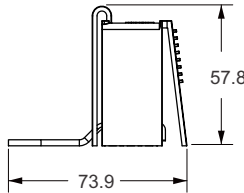
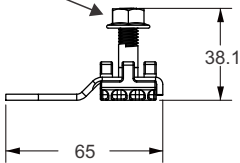

Dimensions in MM



**0FHZ0212Z  
(Dual mounting)**

**DIMENSIONS FOR: 0FHZ00854-BX & 0FHZ00853-BX**

**Fuse Bar**

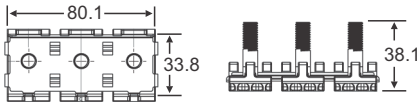

**Battery Bar**

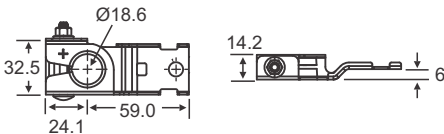

**Cover**



Dimensions in MM

Zcase Fuses →

Battery Bar →



**Positive Battery  
Post Mount**

DIMENSIONS FOR: 0FHZ00854-BX & 0FHZ00853-BX (cont'd).

1 POLE

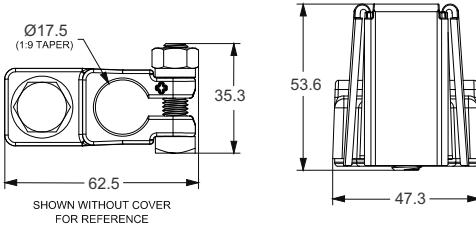

SHOWN WITHOUT COVER FOR REFERENCE

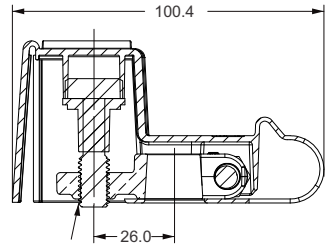

THREADLOCK ON THE BOLT THREADS  
RETENTION TORQUE DEGRADES  
WITH EACH DISASSEMBLY

2 POLE

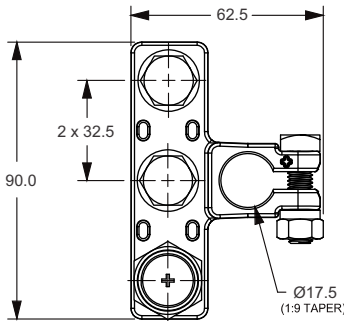

SHOWN WITHOUT COVER FOR REFERENCE

3 POLE

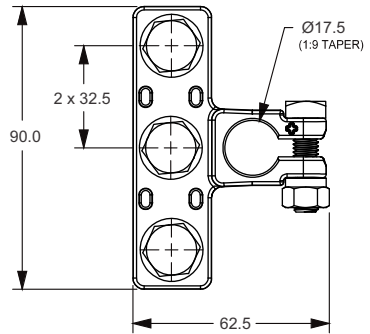

SHOWN WITHOUT COVER FOR REFERENCE

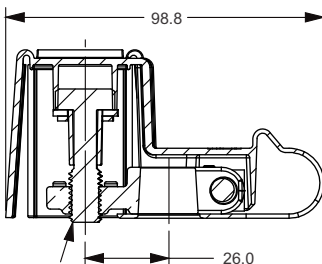

THREADLOCK ON THE BOLT THREADS  
RETENTION TORQUE DEGRADES  
WITH EACH DISASSEMBLY

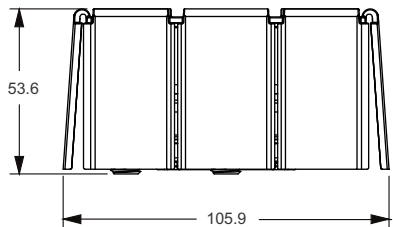

The Zcase is a Minimal Footprint Bolt Down Fuse with a wide rating range up to 600A in the same packaging size. The Time Current characteristic is similar to the well known Mega fuse and fuse ratings up to 250A can be used for full wire protection. Higher fuse ratings mostly used for typically Starter Fuse application as a protector fuse. The fuse can be used directly on a battery post or busbar connection.

### Features:

- Extensive amperage range 40A to 600A.
- Voltage rating 32VDC max.
- Accept mounting terminal size M8 max.
- Several mounting options, stud and post.
- Multi position busbar fed fuse blocks available.



ZCASE Shunt

ZCASE Fuse

M8 Part Number	Ampere Rating	Wire Size	
3298040	40A	4mm <sup>2</sup>	<b>NEW</b>
3298060	60A	6mm <sup>2</sup>	<b>NEW</b>
3298080	80A	10mm <sup>2</sup>	<b>NEW</b>
3298100	100A	16mm <sup>2</sup>	<b>NEW</b>
3298125	125A	16mm <sup>2</sup>	
3298150	150A	25mm <sup>2</sup>	
3298175	175A	25mm <sup>2</sup>	
3298200	200A	35mm <sup>2</sup>	
3298225	225A	35mm <sup>2</sup>	
3298250	250A	50mm <sup>2</sup>	
3298300	300A	35mm <sup>2</sup>	
3298350	350A	35mm <sup>2</sup>	
3298400	400A	50mm <sup>2</sup>	
3298500	500A	50mm <sup>2</sup>	
3298600	600A	50mm <sup>2</sup>	
3298900	Shunt	50mm <sup>2</sup>	<b>NEW</b>

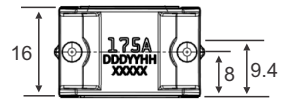
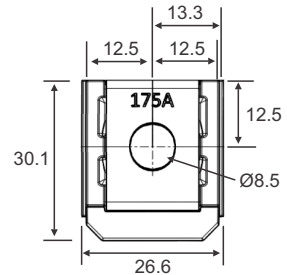

Dimensions in MM

**Voltage:** 32VDC **I.R.:** 2kA at 32VDC

**Characteristic:** Slow Acting

**Cover / Base:** PPA (33% GF)

**Operating Temp:** -40°C to 125°C.

**Insulating Tube:** Ceramic

**Terminal:** Copper Tin Plated

**Mounting:** M6 or M8 stud (40A - 250A), M8 stud (300A - 600A).

**Pack Size (40A-600A & Shunt):** 1, 5, 10, 100, 480

**Holders:** Stud Terminal Mount 1 Way and 2 Stacked.

Top Post Terminal Mount 2 and 3 Way.

Fuse Block 5 and 7 Way.

**Product Options M10 Mounting Terminal Type:**

Battery Fuse Zcase M10 (80A to 600A) 32V, 3298xxx.ZXM10.

Battery Shunt Zcase M10, 32V, 3298900.ZXM10.

Materials Handling Fuse Zcase M10, (70A to 600A) 80V, 3998xxx.ZXM10.

Materials Handling Shunt Zcase M10, 80V, 3998900.ZXM10.

Sealed Battery Fuse Zcase M10, 600A 80VDC Explosion Proof version is

also available with Sealed Fuse Mount also available.

Contact sales for further information.