

POWERVAL CALIBRE FUSE 32V



- Designed for high current circuit protection to protect starter cables.
- Ideal for starter and alternator connectors.
- These fuses allow the load of a starter motor or winch to operate without blowing the fuse, however they will open in the case of a direct short.



| Part Number | Continuous Rated Current | Minimum Melting Current | Maximum Melting Current | Cable Size (mm ²) | Body Colour |
|-------------|--------------------------|-------------------------|-------------------------|-------------------------------|-------------|
| POWCAL1 | 150A | 380A | 2000A | 16 | Grey |
| POWCAL2 | 150A | 400A | 2000A | 25 | Black |
| POWCAL3 | 180A | 530A | 2000A | 50 | Red |
| POWCAL4 | 180A | 600A | 2000A | 50 | Lt. Brown |
| POWCAL5 | 180A | 700A | 2000A | 50 | Dk. Brown |

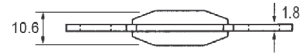
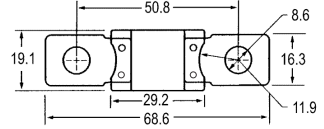

Dimensions in MM

Voltage: 32VDC **I.R.:** 2000A at 32VDC

Characteristic: Slow Acting

Mounting: M8 or 5/16" studs

Terminal: (POWCAL1 - 2) Tin Plated Zinc Alloy.
(POWCAL3 - 5) Tin plated Copper.

Pack Size: 1, 10, 100

Holders: Inline, Fuse Blocks, Power Dist. Unit.

Approvals:

RELATED PRODUCTS:



Inline Fuse Holder
(see p.82)



Fuse Block
(see p.96-101)



Fused PDU
(see p.111-115)

Scan this QR Code for more information



QR Code: 3004

FUSE STRIP WITH HOUSING 48V - 80V



| Part Number | Ampere Rating | Part Number | Ampere Rating |
|-------------|---------------|-------------|---------------|
| FBT030 | 30A | FBT250 | 250A |
| FBT035 | 35A | FBT275 | 275A |
| FBT040 | 40A | FBT300 | 300A |
| FBT050 | 50A | FBT325 | 325A |
| FBT060 | 60A | FBT350 | 350A |
| FBT080 | 80A | FBT355 | 355A |
| FBT100 | 100A | FBT400 | 400A |
| FBT125 | 125A | FBT425 | 425A |
| FBT130 | 130A | FBT500 | 500A |
| FBT150 | 150A | FBT600 | 600A |
| FBT175 | 175A | FBT675 | 675A |
| FBT200 | 200A | FBT750 | 750A |
| FBT225 | 225A | FBT800 | 800A |



UPDATED



Straight Fork and 90 Degree Type Lugs

Voltage: 48VDC (30A-425A), 80VDC (500A-800A)

I.R.: 2.5kA at 48VDC, 4kA at 80VDC.

Characteristic: Fast Acting

Mounting: M10 or 3/8" studs.

Feature: Element window.

Pack Size: 1, 10, 20, 50

Notes: Suitable for battery-powered vehicles.

Approvals: Ref: UL 248, DIN 43560

RELATED PRODUCTS:



Fuse Block & Cover
(see p.101)



Fuse Block
(see p.101)

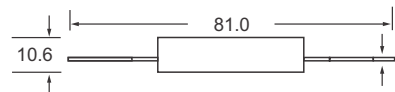
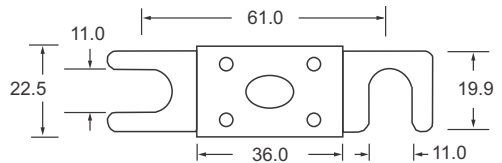

Dimensions in MM

1.0 (<325A)
1.5 (<600A)
2.0 (<800A)