

ELECTRIC VEHICLE PDU FUSES AE6 1000V

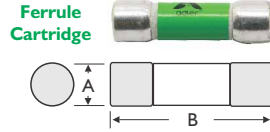

Engineered to provide best in class auxiliary and high performance protection in managing systems of electrical and hybrid electrical vehicles.

Cartridge Part Number	Flush Tag Part Number	Ampere Rating
AE61500A00	AE61500A02	5A
AE61600A00	AE61600A02	6A
AE61800A00	AE61800A02	8A
AE62100A00	AE62100A02	10A
AE62150A00	AE62150A02	15A
AE62200A00	AE62200A02	20A
AE62250A00	AE62250A02	25A
AE62300A00	AE62300A02	30A
--	AE62200B02	20A
--	AE62250B02	25A
--	AE62300B02	30A
AE62350C00	AE62350C02	35A
AE62400C00	AE62400C02	40A
AE62500C00	AE62500C02	50A
AE62600C00	AE62600C02	60A



Series	Amperage	A	B
AE6...A00	5A-30A	10	38
AE6...B00	20A-30A	14	51
AE6...C00	35A-60A	14	65

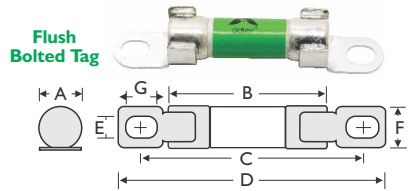

Voltage: 1000VDC **I.R.:** 20kA at 1000VDC.
Time Constant: 2 ± 0.5ms
Terminal Options: Centre tag & PCB mount.
Approvals: ISO 8820-8; GB/T 31465.6; UL 248-20, JASO D622

RELATED PRODUCTS:



Series	Amperage	A	B	C	D	E	F	G
AE6...A02	5A -15A	10.3	38	53.5	64	5.3	12	7
AE6...B02	20A -30A	14.2	51	72.0	86	6.5	12	9.4
AE6...C02	35A -60A	14.2	65	87.0	101	6.5	12	9.4

ELECTRIC VEHICLE PDU FUSES AEX 1000V



Designed for EV / HEV automotive use such as high power EV PDU & battery protection.

Part Number	Ampere Rating
AEX2700731	70A
AEX2800731	80A
AEX2900731	90A
AEX3100731	100A
AEX3125738	125A
AEX3150738	150A
AEX3175738	175A
AEX3200738	200A
AEX3250751	250A
AEX3300751	300A
AEX3350751	350A
AEX3400751	400A
AEX3500751	500A
AEX3600764	600A

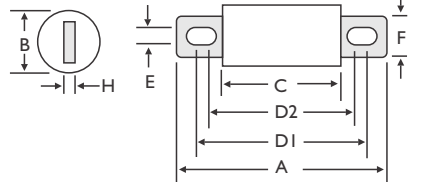

Voltage: 1000VDC **I.R.:** 50kA at 1000VDC
Time Constant: (L/R) 2 ± 0.5ms
Approvals: IEC 60269-4; UL 248-20

RELATED PRODUCTS:



Series	Amperage	A	B	C	D1	D2	E	F	H
AEX...731	70A-100A	125	31	86	109	102	8.5	22	5
AEX...738	125A-200A	140	38	83	118	100	10.5	25	6
AEX...751	250A-500A	146	51	89	126	107	10.5	38	6
AEX...764	600A	196	64	88	162	122	13	50	10

FUSES + KITS