

# AUTO FUSE BLOCKS LATERAL CONNECTION



**IPX4**

**Features:**

- Clear plastic cover for fast visual confirmation of fuse amp rating.
- Easy identification of blown fuses when LED indicating Auto fuses are installed.
- Gasket included with cover.

Part Number	No. Poles	Max Amps Per Block
00610K	4 Pole	80A
00600K	6 Pole	100A
00590K	8 Pole	135A

**Voltage:** 32V

**Input Terminal Rating:** 20A max. per circuit.

**Body:** Black PA66 GF30

**Cover:** Transparent cover with gasket. Material PA12.

**Terminals:** Lateral connections, 6.35mm (1/4") QC terminals.

**Kit Contents:** Fuse cover, base & QC terminals.

**Mounting:** M5 screw

**Pack Size:** 1, 10, 100, 500

**Notes:** Each fuse branch is independently powered.  
Fuses are not included.

**Approvals:** RoHS

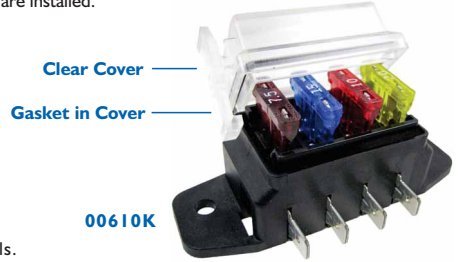

**Lateral Connection  
1/4" Quick Connects**

FUSE HOLDERS

**Mounting Diagram - 00610K**

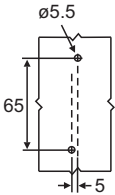

**4 Way Lateral Kit**

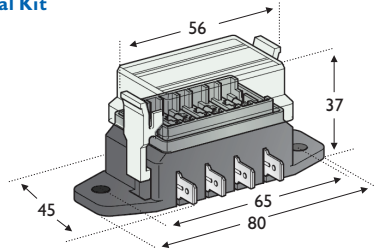

**Mounting Diagram - 00600K**

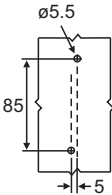

**6 Way Lateral Kit**

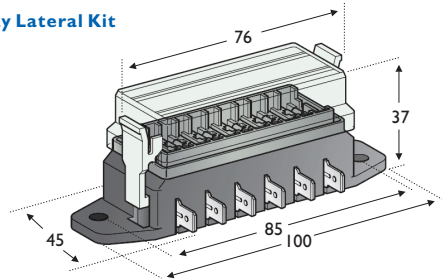

**Mounting Diagram - 00590K**

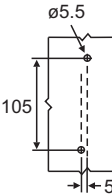

**8 Way Lateral Kit**

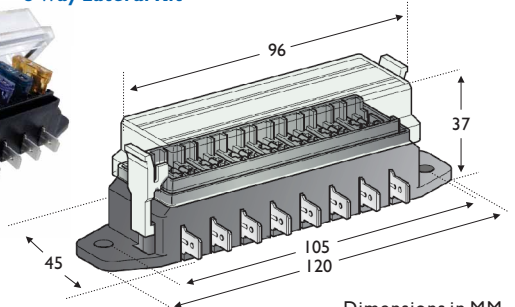

**RELATED PRODUCTS:**

**Auto & LED Auto Fuses** (see p.17)

Dimensions in MM