

MIDI & MEGA MULTI-POLE COMBINATION FUSE BLOCKS



NEW

Part Number	Description
0101499	Midi Fuse Block M5 Studs with Hinged Cover
0101224	Midi Single Input Stud M5 with Hinged Cover
0101498	Mega Fuse Block M8 Studs with Hinged Cover
0101223	Mega Single Input Stud M8 with Hinged Cover
0301509	Busbar 2 x Midi Fuse Positions
0301508	Busbar 3 x Midi Fuse Positions
0301227	Busbar 5 x Midi Fuse Positions
0301511	Busbar 1 x Midi Position & 2 x Mega Positions
0301251	Busbar 2 x Midi Positions & 1 x Mega Position
0301512	Busbar 2 x Midi Positions & 2 x Mega Positions
0301250	Busbar 3 x Midi Positions & 1 x Mega Position
0301249	Busbar 4 x Midi Positions & 1 x Mega Position
0301226	Busbar 4 x Midi Positions & 3 x Mega Positions
MGBB02	Busbar 2 x Mega Fuse Positions
MGBB03	Busbar 3 x Mega Fuse Positions



Base: Black PBT-GF20 **Cover:** Black PP-TD20 HEAT-ST Cu-ST
Hardware Midi Fuse & Midi Input Block: Steel - Zn Ni. (M5)
Hardware Mega Fuse & Mega Input Block: Steel - Zn Ni. (M8)
Fuse Block / Single Input Block: Includes cover & hex nut(s)
Crimp Tool: Suit Tubular terminals refer page 184
Notes: Rear plastic panel must be cut out if not fitting a busbar
 Single stud power input blocks are also gangable to fuse blocks

Features

- Fuse Block & Single Stud Input Block
- Midi or Mega Fuse Models
- Hinged Cover - Finger Lift
- Gangable - Multiple or Combination
- Busbar Accessories

FUSE HOLDERS

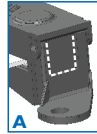
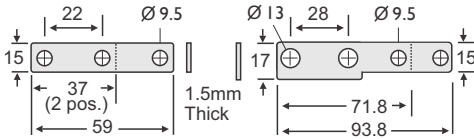

Removable Wall

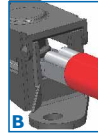

Input Cable

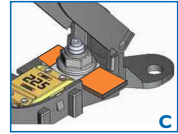

Busbar Accessory No Cut-out Required

Midi Busbar Multiple Positions

Mega & Midi Busbar Multiple Combinations



Combination Ganged Fuse Blocks. Midi Block + Mega Block.

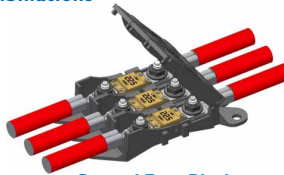

Ganged Fuse Blocks Independent Power.



Ganged Fuse Blocks with Common Busbar Power.

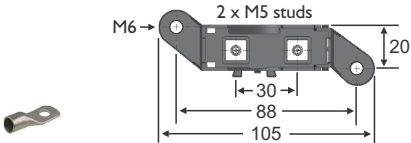
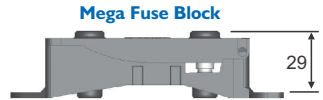
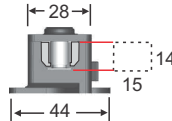
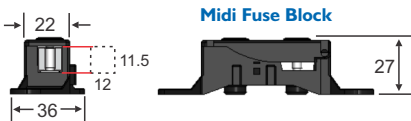

Midi M6 Tubular Terminal (see p188).

Dimensions in MM

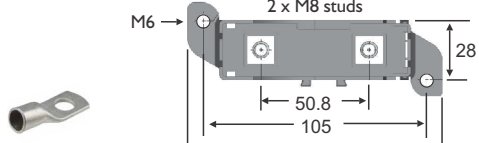

Mega M8 Tubular Terminals (see p188).

Dimensions in MM

Midi Fuses
See page 24.



Mega Fuses
See page 25-26.

